

# Rheem On-Tap

## Instant Boiling and Chilled Filtered Water System

### Features and Benefits

#### Modular Design Maximises Space

The modular design of the boiling and chilling units maximises under-counter space and makes installation easy and a built-in safe tray eliminates the need for a separate tray and drainage.

#### Easy-to-Operate Smart Design suits any Kitchen

Can be mounted on a sink, or on a bench top with the Rheem sink-free kit that incorporates drainage grate and tap extension. Soft-tipped activation levers feature momentary and lock-on positions to assist with filling cups or jugs.

#### Child-Proof Safety Lock means Added Safety

Requires two-finger operation to be activated and prevents boiling water being dispensed inadvertently.

#### Filter Light indicates when Filter Replacement is due

Depending on water quality, the volume of water consumed prior to activation of the filter replacement light can be as low as 1,000 litres and is adjustable up to 14,000 litres in increments of 1,000 litres. The bayonet-fitted filter cartridge makes filter replacement easy.

#### Electronic Control means Precise Temperature Control

An electronic control board controls the operation of the boiling water system. This provides automatic temperature calibration and precise temperature control and ensures temperature is within 3°C of boiling point. The temperature override function allows the boiling water temperature to be set between 70°C and 99°C.

#### Automatic Calibration ensures Correct Boiling Temperature

At first start up, the system determines the boiling point and automatically calibrates an offset below this. The boiling point of water is 100°C at sea level and reduces in temperature depending on the altitude above sea level. For example:  
 - 300 - 600 metres - 97°C (Canberra, Mt Isa, Kalgoorlie)  
 - 600 - 1200 metres - 96°C (Bathurst, Bowral, Toowoomba)  
 - 1200 metres and over - 95°C (Snowy Mountains).

#### 7 Day Timer reduces Running Costs

The built-in programmable timer with a separate on and off time for each day meets the energy efficiency requirements of Specification J6 of the Building Code of Australia (BCA). This reduces running costs by enabling the unit to be turned off when the system is not in use. (See Notes.)

#### Sleep Mode saves Energy

The Sleep Mode, when activated, will turn the system off when no use has occurred for a specified time (either 1, 2, 3, 4, 5 or 6 hours). This reduces running costs when the system is not in use. (See Notes.)



Rheem On-Tap sink-mounted system

#### Energy Efficiency Information

##### Typical 24 Hour Business Day

Power Usage (kWh)	Globe Equiv (Watts)	CO <sub>2</sub> Emission (kg)	Cost (Per Day)
1.145	47.7	0.938	\$0.14

##### Power required for each cup/glass

Power Usage (Watt Hours)		CO <sub>2</sub> Emission (kg)		Cost (\$ Per Cup/Glass)	
Boiling	Chilled	Boiling	Chilled	Boiling	Chilled
12	3.1	0.0098	0.0025	0.0014	0.0004

#### Notes:

12 hours operational mode during a typical 24 hour business day with 12 hours in sleep mode and 10 minutes for full recovery.

In sleep mode the system powers down if not used for between one and six hours.

Assumes boiling water at 98°C and chilled water at 10°C.

Globe equivalent gives the wattage of a light globe using the same number of watt hours over a 24 hour period as the Rheem system.

CO<sub>2</sub> emissions are based upon 820 kg of CO<sub>2</sub> per 1000 kWh of electrical power consumed.

The cost per day is based upon \$0.12 per kWh.

Since energy costs may differ between providers, please consult your provider to confirm their charges per kWh.

**Warranty\*: 2 years parts and labour 5 years on the tank.**

# Rheem On-Tap

## Instant Boiling and Chilled Filtered Water System

### Installation

Installation of the tap is simple. It requires a 35 to 40 mm hole to be drilled in the bench top and can then be mounted and tightened with the supplied washer and nut. The design is suitable for all standard bench types and thicknesses. The sink-free kit allows the tap to be bench top-mounted without a sink. This boiling water unit must be installed in accordance with the Installation Instructions supplied with the unit and with all local codes and regulatory authority requirements.

### Electrical

The installation must comply with AS/NZS 3000, the Australian/New Zealand Wiring Rules. A 220-240 V AC power supply is required.

### Plumbing

The installation must be carried out by a licensed plumber and must comply with AS/NZS 3500.4, Plumbing and Drainage – Heated Water Services. The unit can be connected directly to a drinking water supply with pressure in accordance with the table below.

### Tap and Sink-free Kit Specifications

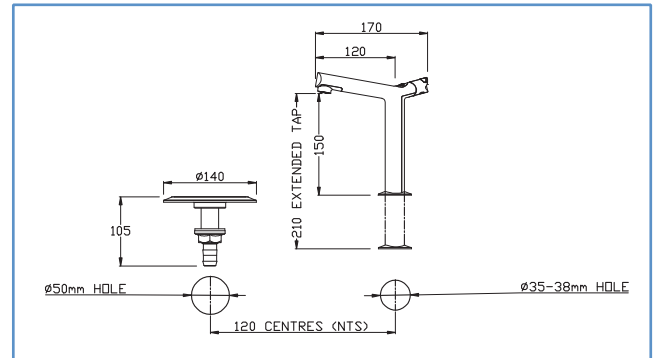

### TB and Chiller Dimensions

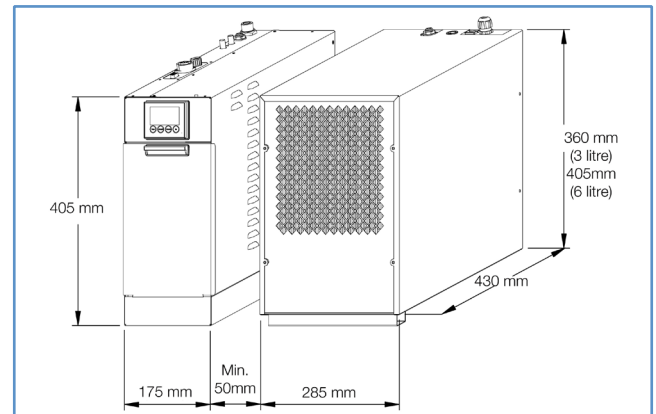

### Sample Specification

The boiling and chilled water system shall be a Rheem On-Tap system, model number (insert model no.) with an initial draw off of 31 x 170ml cups (24 for 3L model) of boiling water and 30 x 200ml glasses (15 for 3L model) of chilled water. The system should be air cooled and the chilled water temperature should be adjustable between 5° and 15° C and the boiling water between 70° C and 99° C. A child-proof safety lock is mandatory to prevent boiling water from being dispensed inadvertently.

The under-sink units should be modular to allow for flexible installation and should incorporate a built-in safe tray. To save energy, a user-programmable 7 day timer and sleep mode that meets BCA requirements should automatically power the unit down when not in use.

Rheem on-tap series		Filtered Boiling & Drinking Water							
Model (Specification Code)	TB3CHP3 (740003)		TB3CHP6 (740006)		TB5CHP3 (75003)		TB5CHP6 (75006)		
	Boiling Unit	Chilled Unit	Boiling Unit	Chilled Unit	Boiling Unit	Chilled Unit	Boiling Unit	Chilled Unit	
Nominal size	3	3	3	6	5	3	5	6	
Cups <sup>1</sup> (initial)	24	15	24	30	31	15	31	30	
Cups per Hour	145	125	145	175	170	125	170	175	
Approx Weight Empty	12kg	13kg	12kg	15kg	12kg	13kg	15kg	15kg	
Approx Weight Full	18kg	16kg	18kg	21kg	18kg	16kg	18kg	21kg	
Minimum Water Supply Pressure	50kPa	-	50kPa	-	50kPa	-	50kPa	-	
Maximum Water Supply Pressure	1000kPa	-	1000kPa	-	1000kPa	-	1000kPa	-	
Input	1.5kW	.28kW	1.8kW	0.32kW	1.8kW	0.28kW	1.8kW	0.32kW	
Electrical Connection	Supplied with 10 Amp 3 pin plug & flex								
Plumbing Connection	1/2" BSPF	1/4" John Guest	1/2" BSPF	1/4" John Guest	1/2" BSPF	1/4" John Guest	1/2" BSPF	1/4" John Guest	
A Width	175mm	285mm	175mm	285mm	175mm	285mm	175mm	285mm	
B Depth	450mm	430mm	450mm	430mm	450mm	430mm	450mm	430mm	
C Height	405mm	360mm	405mm	405mm	405mm	360mm	405mm	405mm	
Clearance	-	50mm	-	50mm	-	50mm	-	50mm	
Accessories									
Sink-free Kit - Part No: 317453	Optional	Optional	Optional	Optional	Optional	Optional	Optional	Optional	
Discreet Ventilation Kit: Part No: 317255	Optional	Optional	Optional	Optional	Optional	Optional	Optional	Optional	



Quality System  
Quality Endorsed Company  
ISO 9001  
Lic. QEC 14766  
SAI Global



WaterMark  
AS3498  
Lic. WMK A0177  
SAI Global

### Warranty\*

**2 Years**  
Parts & Labour  
**5 Years**  
On the tank

\* Conditions apply.  
For full warranty, please contact Rheem or see Installation Manual.

1. Cup size = 170ml. Glass size for chilled water = 200ml.

Materials and specifications are subject to change without notice due to ongoing product improvements. Rheem is a Registered Trade Mark of Rheem Australia Pty Ltd.

